



RETRIEVER 35™

User Installation Instructions

EXTENDED & GROUND LOCK POST MOUNTING KITS

IMPORTANT NOTE:- ENSURE THAT ALL RELEVANT PERSONNEL READ THE POINTS LISTED BELOW AND THAT A COPY IS PASSED ON TO STAFF INVOLVED WITH THE INSTALLATION

KIT CONTENTS:

1) Extended or ground lock post	x 1
2) M5 x 10mm pan head slotted screw	x 2
3) M6 shakeproof washer*	x 2
4) M10 x 21mm bright washer	x 1
5) M10 x 70mm hex head bolt	x 1
6) Ground socket	x 1
7) M6 x 20mm mushroom head screw	x 2
8) M6 nylon washer	x 4
9) M6 nyloc nut	x 2

* for ground lock post kit only

EQUIPMENT REQUIRED:

Screwdriver & 10mm Spanner

ASSEMBLY INSTRUCTIONS:

- Open the Retriever 35 bin with the key.
- Release quarter turn fastener to part separate the bin from the spine.
- Depress the spring clip from the spine and lift away the bin body.

Offer the rear of the spine up to the post (1). Align the four fixing holes and hold in place. Place the shakeproof washer (3) onto each M5 x 10 Pan head screw (2) (x2). Insert the screws through the upper mounting holes in the spine and screw securely into the post.

Insert a nylon washer (8) onto each M6 x 20 mushroom head screw (x2). Insert the screws through the lower fixing holes in the spine and the post. Place a nylon washer (8) onto the exposed end of the screws and secure with an M6 nyloc nut (9) (x2).

- Re-assemble the bin body back to the spine using spring clip & quarter turn fasteners.

(For post installation see reverse page)

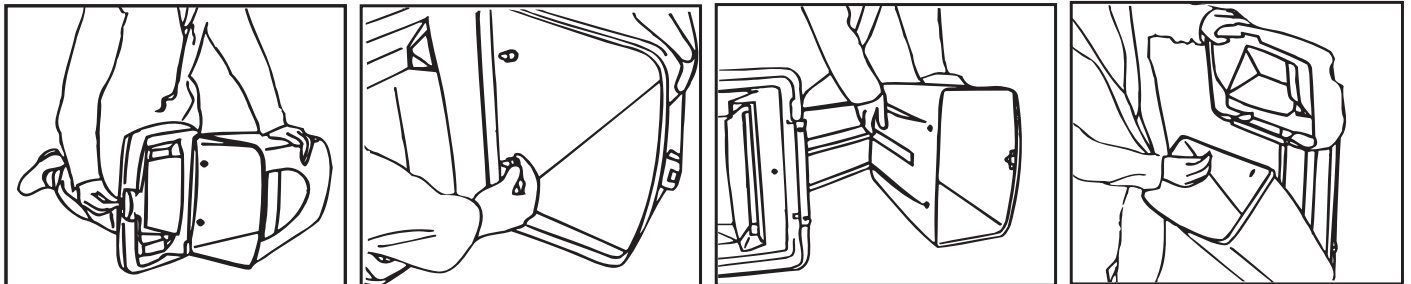
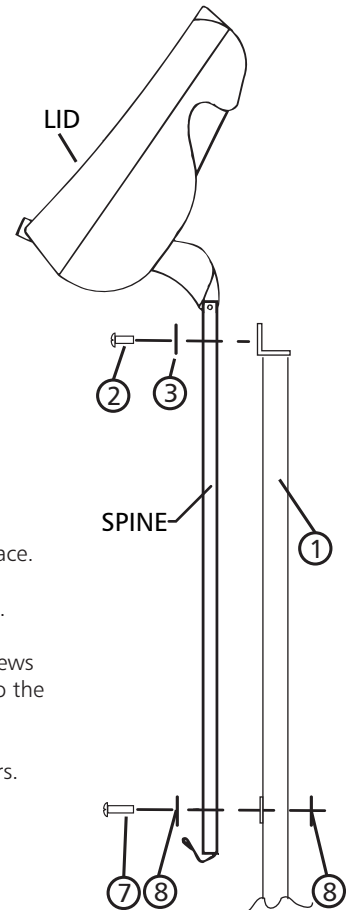

- A planned maintenance schedule of regular inspection is recommended, Replacing components as necessary.
- Replacement components are available direct from GLASDON.
- GLASDON cannot be held responsible for claims arising from incorrect installation, unauthorised modifications or misuse of the product.

 **Glasdon®** AND RETRIEVER 35™ ARE TRADEMARKS OR REGISTERED TRADEMARKS OF GLASDON GROUP OR ITS SUBSIDIARIES IN THE U.K. AND OTHER COUNTRIES



Glasdon U.K. Limited

Preston New Road
BLACKPOOL
Lancashire
FY4 4UL

Tel: (01253) 600410
Fax: (01253) 792558
e-mail: sales@glasdon-uk.co.uk
web: www.glasdon.com